

CAT | RACKING – HEAVY DUTY

Product: PALLET | LONG SPAN RACKING

UNI-RACK H-duty racking system allows economical use of storage space. Access – selection of product & speed of operation. Pallets are fully accessible allowing easy access by Forklift or Reach Truck.

A wide variety of beam and frame sizes are available, designed & calculated to client specific requirements. Beam levels are boltless & easily adjusted to specific pallet height requirements. Additional equipment / Safety accessories include Upright and Row End Protectors.

Racking can be used for pallet application-placement alternatively, **Decking** of types Pre-Galvanized, Powder Coated Steel Decks, Timber Decking and Skid Channels. UNI-RACK H-duty racking system has a wide selection of beams : length of bay and carrying capacity is designed & calculated according to clients specific requirements.

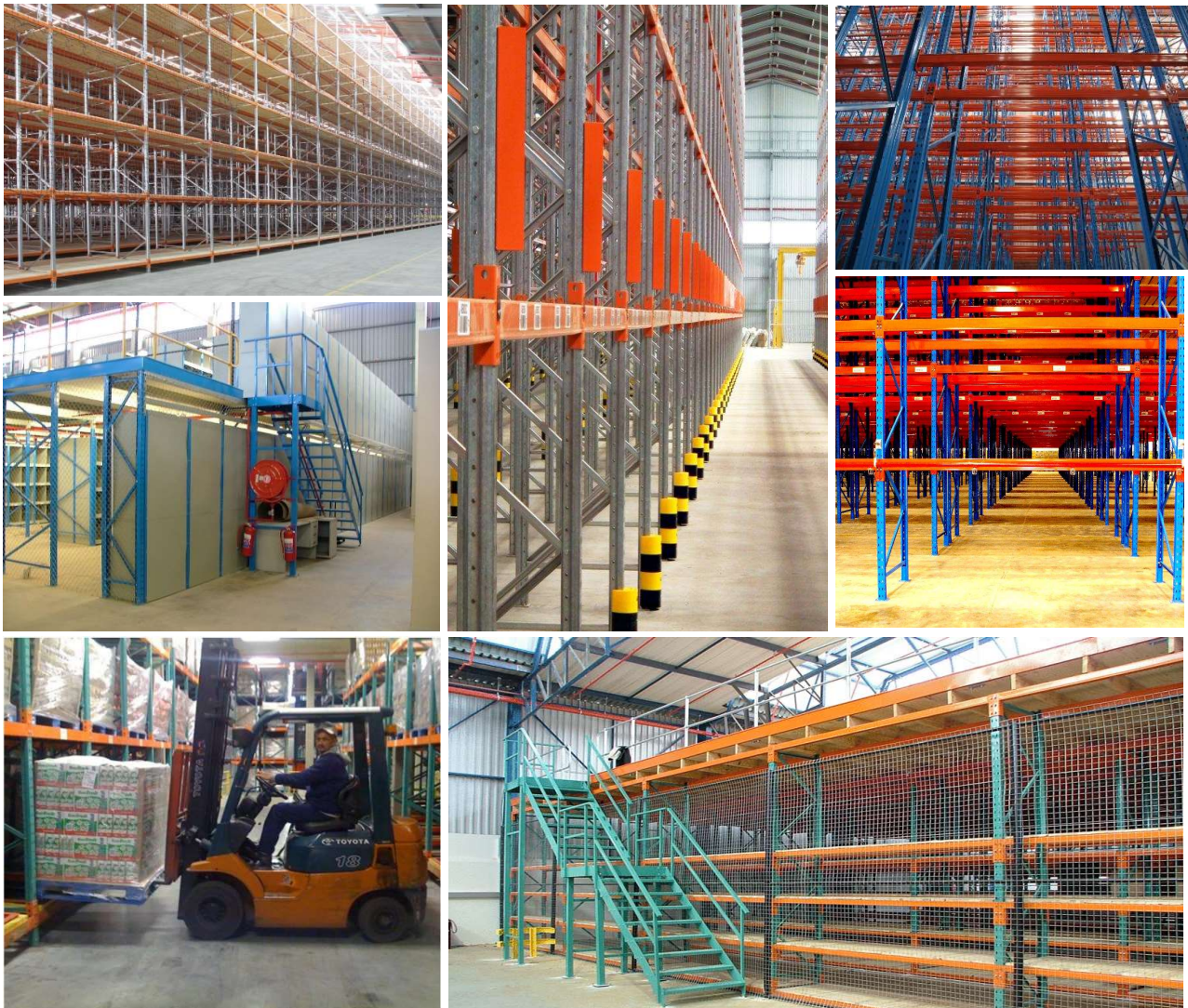

interiors | shop fitting | office fitting | shelving & racking | materials handling | display stands | bins & crates | notice boards | cupboards & cabinets | mezzanine floor | pallets | lockers | architectural systems | screens & partitions | promotion stands | scaffolding | metal bending | metal perforation | metal powder coating

CAT | RACKING – HEAVY DUTY

Product: PALLET | LONG SPAN RACKING

UNI-RACK H-duty racking system allows economical use of storage space. Access – selection of product & speed

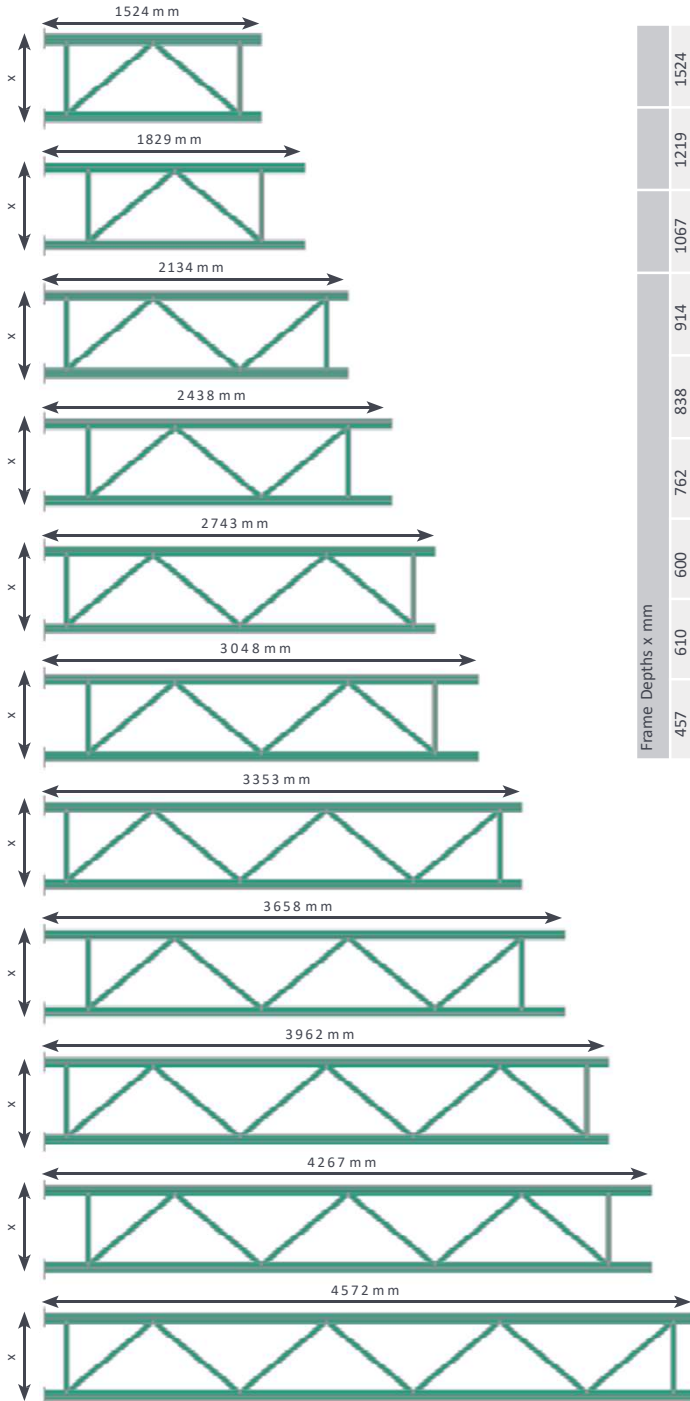

Frames are available in:

Light Duty
Standard Duty
Medium Duty
Heavy Duty
X-Heavy duty

Decking options:

MDF Wood
Slatted-Pine –industrial FS
Pallet – Steel-Wood-PVC

interiors | shop fitting | office fitting | shelving & racking | materials handling | display stands | bins & crates | notice boards | cupboards & cabinets | mezzanine floor | pallets | lockers architectural systems | screens & partitions | promotion stands | scaffolding | metal bending | metal perforation | metal powder coating

HD Racking Support Beams

Beams are Boltless – easily adjusted at a pitch of 75mm

Beams are secured with 2 Beam Connector Lock (Spring Clip Insert Shear Pin)

Special Length beams can be engineered / supplied (T&C's may apply)

Assorted Decking options are available (refer to decking section)



75mm Open Beams



Beam Lengthmm											
914	1219	1524	1829	2134	2438	2743	3048	3353	3658	3962	4267
Beam Loading max. kg per pair of beams - UDL (Uniformly Distributed Load)											
2960	2220	1770	1480	1260	965	765	620	510	430	365	315

75mm Box Beams



Beam Lengthmm											
914	1219	1524	1829	2134	2438	2743	3048	3353	3658	3962	4267
Beam Loading max. kg per pair of beams - UDL (Uniformly Distributed Load)											
4000	3470	2780	2325	1990	1645	1325	1090	915	783	680	590

95mm Box Beams



Beam Lengthmm											
914	1219	1524	1829	2134	2438	2743	3048	3353	3658	3962	4267
Beam Loading max. kg per pair of beams - UDL (Uniformly Distributed Load)											
4000	4000	3680	3065	2627	2300	2044	1745	1455	1235	1065	925

115mm Box Beams



Beam Lengthmm											
914	1219	1524	1829	2134	2438	2743	3048	3353	3658	3962	4267
Beam Loading max. kg per pair of beams - UDL (Uniformly Distributed Load)											
4000	4000	4000	3815	3265	2860	2545	2290	2080	1910	1760	1600

135mm Box Beams



Beam Lengthmm											
914	1219	1524	1829	2134	2438	2743	3048	3353	3658	3962	4267
Beam Loading max. kg per pair of beams - UDL (Uniformly Distributed Load)											
4500	4500	4500	4500	4130	3620	3220	2900	2635	2415	2230	1985

155mm Box Beams



Beam Lengthmm											
914	1219	1524	1829	2134	2438	2743	3048	3353	3658	3962	4267
Beam Loading max. kg per pair of beams - UDL (Uniformly Distributed Load)											
4500	4500	4500	4500	4500	4370	3890	3500	3180	2915	2690	2500

interiors | shop fitting | office fitting | shelving & racking | materials handling | display stands | bins & crates | notice boards | cupboards & cabinets | mezzanine floor | pallets | lockers architectural systems | screens & partitions
promotion stands | scaffolding | metal bending | metal perforation | metal powder coating